	E QUIPAGGIAMENTI T ECNICI L AVAGGIO	26.1320.00 RACCORDO GIREVOLE INOX 90° SW90 S.S. 90 DEG. SWIVEL SW90	 	5
				06/11/08

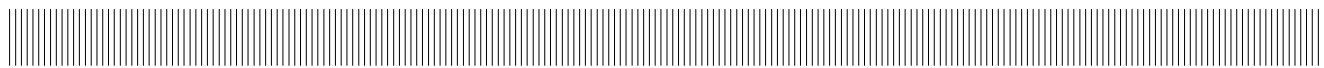

CARATTERISTICHE TECNICHE SPECIFICATIONS

- PRESSIONE NOMINALE <i>RATED PRESSURE</i>	350 bar – 35 MPa (5100 psi)
- PRESSIONE CONSENTITA <i>PERMISSIBLE PRESSURE</i>	390 bar – 39 MPa (5650 psi)
- PORTATA MASSIMA <i>MAX FLOW RATE</i>	80 l/min (21 USG p.m.)
- TEMPERATURA MASSIMA DI LAVORO (UTILIZZO CONTINUO) <i>MAX WORKING TEMPERATURE (CONTINUOUS USE)</i>	90° C (194°F)
- TEMPERATURA MASSIMA AMMESSA (SOLO PER BREVI PERIODI) <i>MAX PERMISSIBLE TEMPERATURE (FOR SHORT PERIODS ONLY)</i>	160° C (320°F)
- NUMERO DEI GIRI MAX <i>MAX RPM</i>	30 giri/min (30 rpm)
- COPPIA ALLA PRESSIONE NOMINALE <i>TORQUE AT RATED PRESSURE</i>	~ 4.5 Nm (40 Lbs.in)
- MATERIALE <i>MATERIAL</i>	PERNO E CORPO IN ACCIAIO INOX <i>STAINLESS STEEL PIN AND BODY</i>
- GUARNIZIONI <i>SEALS</i>	OR IN FKM (VITON) + ANELLO IN TEFLON <i>O-RING SEALS IN FKM (VITON) + TEFLON RING</i>

MISURE D'INGOMBRO OVERALL DIMENSIONS

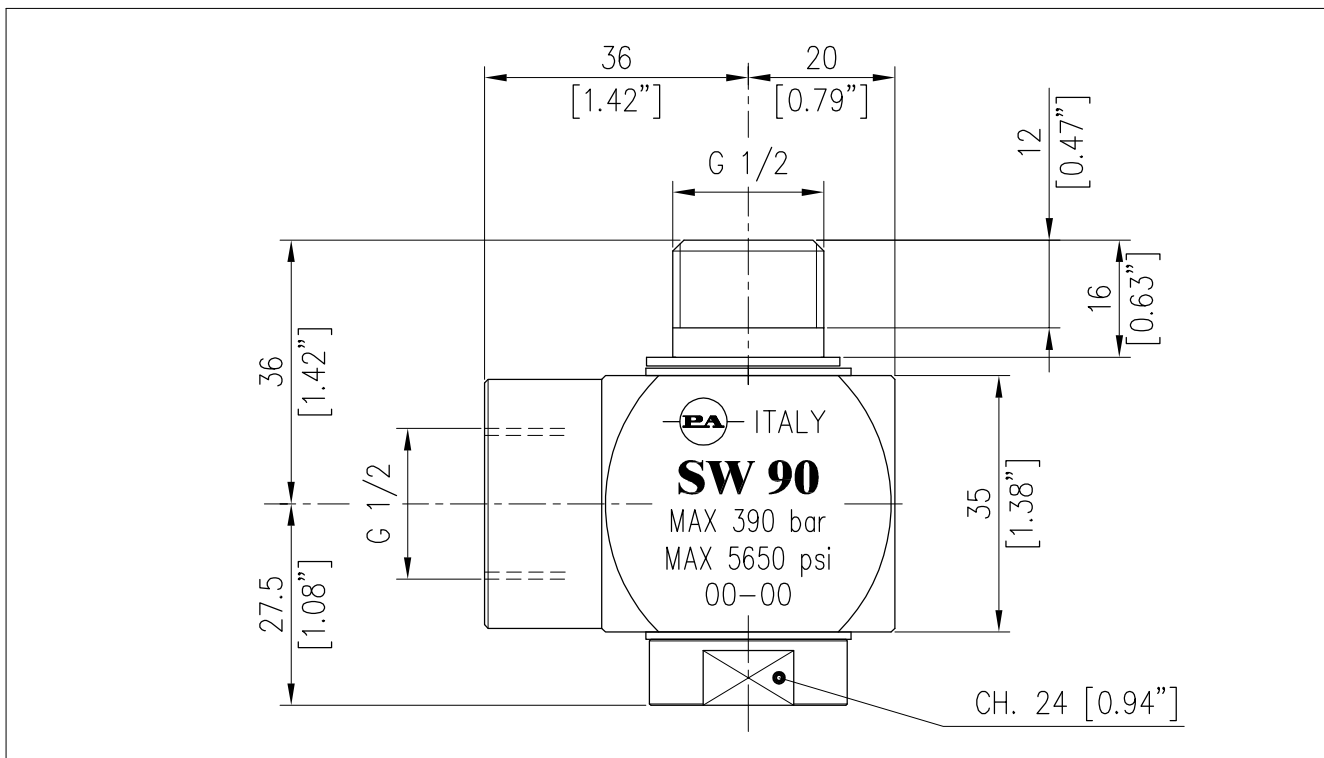

26.1320.00 SW90 Giunto gir. 90° inox G1/2 MF

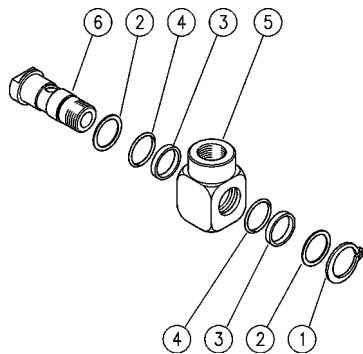



Pos.	Codice	Descrizione	Q.tà	K1	K2	K3	K4	
1	10.1020.05	An. elast. E 20 inox	1					10
2	14.4060.22	Rosetta 22,3x28x1 mm inox	2	•				10
3	10.2067.00	Anello di tenuta 22x25,5x4,1mm	2	•				10
4	10.3242.10	An.OR 3,53x23,4 mm Vi 70	2	•				10
5	26.1321.51	Corpo SW90 G1/2F inox	1					2
6	26.1322.51	Vite forata G1/2 M inox	1					3

Kit	Codice	Descrizione	
K1	26.1325.24	Kit ric. Sw90-inox 3x1pz.	1

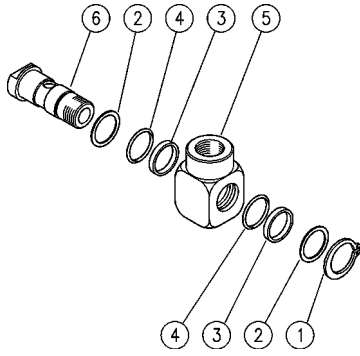
26.1320.00 SW90 Swivel 90°, sst, 1/2 MF Bsp



Pos.	P/N	Description	Q.ty	K1	K2	K3	K4	
1	10.1020.05	Snap ring, E 20 Sst.	1					10
2	14.4060.22	Washer, 22,3x28x1 mm Sst.	2	•				10
3	10.2067.00	Seal ring, 22x25,5x4,1 mm	2	•				10
4	10.3242.10	O-ring, 3,53x23,4 mm Vi 70	2	•				10
5	26.1321.51	Housing -SW90, 1/2F Bsp Sst.	1					2
6	26.1322.51	Pierced screw, 1/2M Bsp Sst.	1					3

Kit	P/N	Description	
K1	26.1325.24	Spares kit -Sw90,-Sst. 3x1pcs.	1



P.A. S.p.A.

Via Milano, 13
42048 Rubiera, Reggio Emilia - Italy

Tel +39.0522.623611
Fax +39.0522.629600

info@pa-etl.it

www.pa-etl.it



COMPANY WITH QUALITY MANAGEMENT
SYSTEM CERTIFIED BY DNV
= ISO 9001 =